



Full Closures on I-75 Northbound at Miramar Parkway Scheduled to Begin on Saturday, June 13

The Florida Department of Transportation (FDOT) is scheduled to close all northbound lanes along I-75 at Miramar Parkway to allow crews to demolish part of the existing Miramar Parkway Bridge. In order to perform this work safely, traffic will be detoured during the following dates and times:

All lanes of I-75 northbound will be closed at Miramar Parkway from 11 p.m. Saturday, June 13 to 8 a.m. Sunday, June 14. Motorists will be detoured to take the exit ramp at Miramar Parkway East (Exit 7A), at the top of the ramp cross over Miramar Parkway, and re-enter I-75 northbound using the Miramar Parkway on-ramp.

All lanes of I-75 northbound at Miramar Parkway will be closed from 8 a.m. Sunday, June 14 to 5 a.m. Monday, June 15. Motorists on I-75 northbound will be detoured to take the exit ramp at Miramar Parkway East (Exit 7A), continue eastbound on SW 145 Avenue, then north on SW 145 Avenue to Pines Boulevard and continue westbound on Pines Boulevard to re-enter northbound I-75. Please follow the posted detour.

To download a detour map please visit: www.75-express.com/project-information/news/updates

Please note that this schedule may change due to inclement weather or other unexpected conditions.

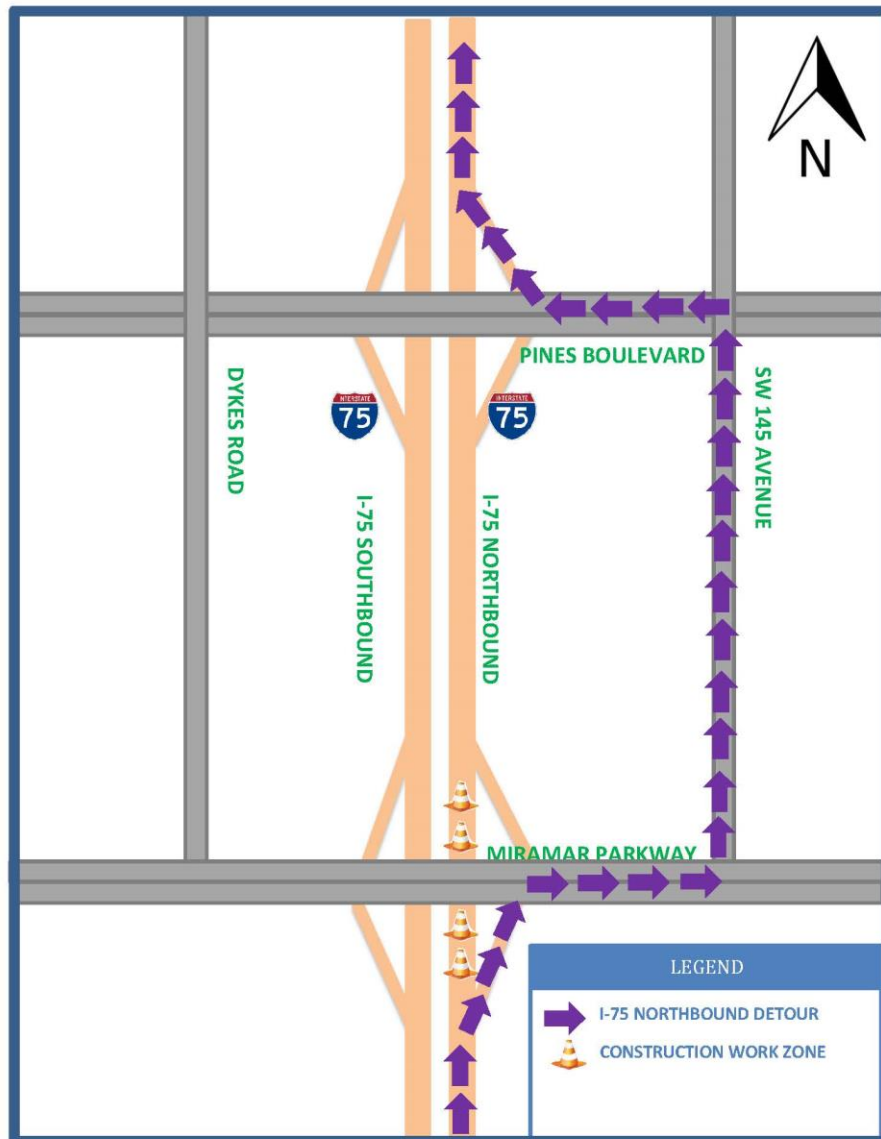

CONTACT

FOR MORE INFORMATION OR TO RECEIVE PROJECT UPDATES,
PLEASE CONTACT THE PROJECT PUBLIC INFORMATION OFFICER,
FIORELLA ALVAREZ, AT 954.548.2754 OR VIA E-MAIL AT
FIORELLA@ISCPRGROUP.COM

STAY CONNECTED