

75 EXPRESS LANE PROJECT



CONSTRUCTION UPDATE



I-75 Northbound and Southbound Ramp Closures At Griffin Road Scheduled to Continue

The Florida Department of Transportation (FDOT) is scheduled to close the I-75 northbound and southbound exit ramps at Griffin Road to complete paving and guardrail operations. In order to perform this work safely, traffic will be detoured during the following dates and times:

- The I-75 northbound exit ramp to westbound Griffin Road (Exit 13B) will be closed intermittently **Sunday, August 13 through Thursday, August 17 between 10 p.m. and 5 a.m.** Motorists will be detoured to exit at Sheridan Street East (Exit 11), continue east on Sheridan Street to Flamingo Road and north on Flamingo Road to Griffin Road. Please follow the posted detour. **Please be advised that this ramp closure will not occur simultaneously with the ramp closure of I-75 southbound at Griffin Road.**
- The I-75 southbound exit ramp to eastbound Griffin Road (Exit 13A) will be closed intermittently **Sunday, August 13 through Thursday, August 17 between 10 p.m. and 5 a.m.** Motorists will be detoured to exit at Griffin Road West (Exit 13B), continue west on Griffin Road to Dykes Road and make a U-turn at Dykes Road to go east. Please follow the posted detour. **Please be advised that this ramp closure will not occur simultaneously with the ramp closure of I-75 northbound at Griffin Road.**
- The I-75 southbound entrance ramp from eastbound and westbound Griffin Road will be closed **Tuesday, August 15 through Thursday, August 17 between 10 p.m. and 6 a.m.** Motorists traveling eastbound and westbound on Griffin Road will be detoured to Flamingo Road, then south on Flamingo Road to Sheridan Street and west on Sheridan Street to take the I-75 southbound entrance ramp. Please follow the posted detour. **If necessary to complete this work, these ramp closures will also take place from 10 p.m. Thursday, August 17 to 6 a.m. Friday, August 18.**

Please note that this schedule may change due to inclement weather or other unexpected conditions.

CONTACT

For more information or to receive updates, please contact the project Public Information Officer, Gerdy St. Louis, at 954.548.2754 or via e-mail at gerdy@iscprgroup.com

STAY CONNECTED



75-express.com



[@myfdot_sefl](https://twitter.com/myfdot_sefl)



www.fl511.com



smartsunguide.com



I-75 NORTHBOUND TO GRIFFIN ROAD WESTBOUND DETOUR MAP



The I-75 northbound exit ramp to westbound Griffin Road (Exit 13B) will be closed intermittently Sunday, August 13 through Thursday, August 17 between 10 p.m. and 5 a.m. Motorists will be detoured to exit at Sheridan Street East (Exit 11), continue east on Sheridan Street to Flamingo Road and north on Flamingo Road to Griffin Road and head west. Please follow the posted detour. Please note that this schedule may change due to inclement weather or other unexpected conditions.

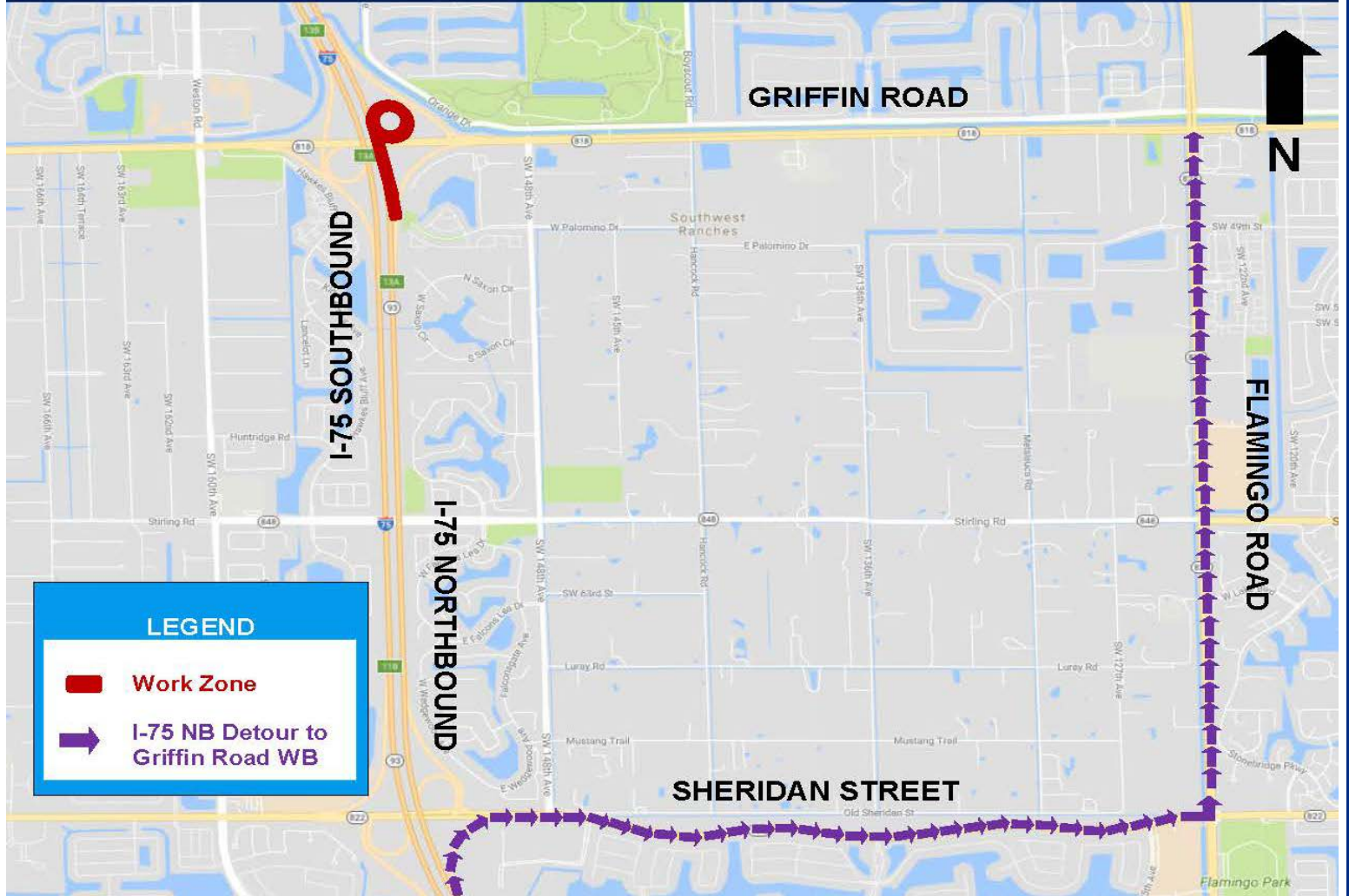

Please note that this schedule may change due to inclement weather or other unexpected conditions.

CONTACT

For more information or to receive updates, please contact the project Public Information Officer, Gerdy St. Louis, at 954.548.2754 or via e-mail at gerdy@iscprgroup.com

STAY CONNECTED



75-express.com



[@myfdot_sefl](https://twitter.com/myfdot_sefl)



www.fl511.com



smartsunguide.com



I-75 SOUTHBOUND TO GRIFFIN ROAD EASTBOUND DETOUR MAP



The I-75 southbound exit ramp to eastbound Griffin Road (Exit 13A) will be closed intermittently Sunday, August 13 through Thursday, August 17 between 10 p.m. and 5 a.m. Motorists will be detoured to exit at Griffin Road West (Exit 13B), continue west on Griffin Road to Dykes Road and make a U-turn at Dykes Road to continue east. Please follow the posted detour. Please note that this schedule may change due to inclement weather or other unexpected conditions.

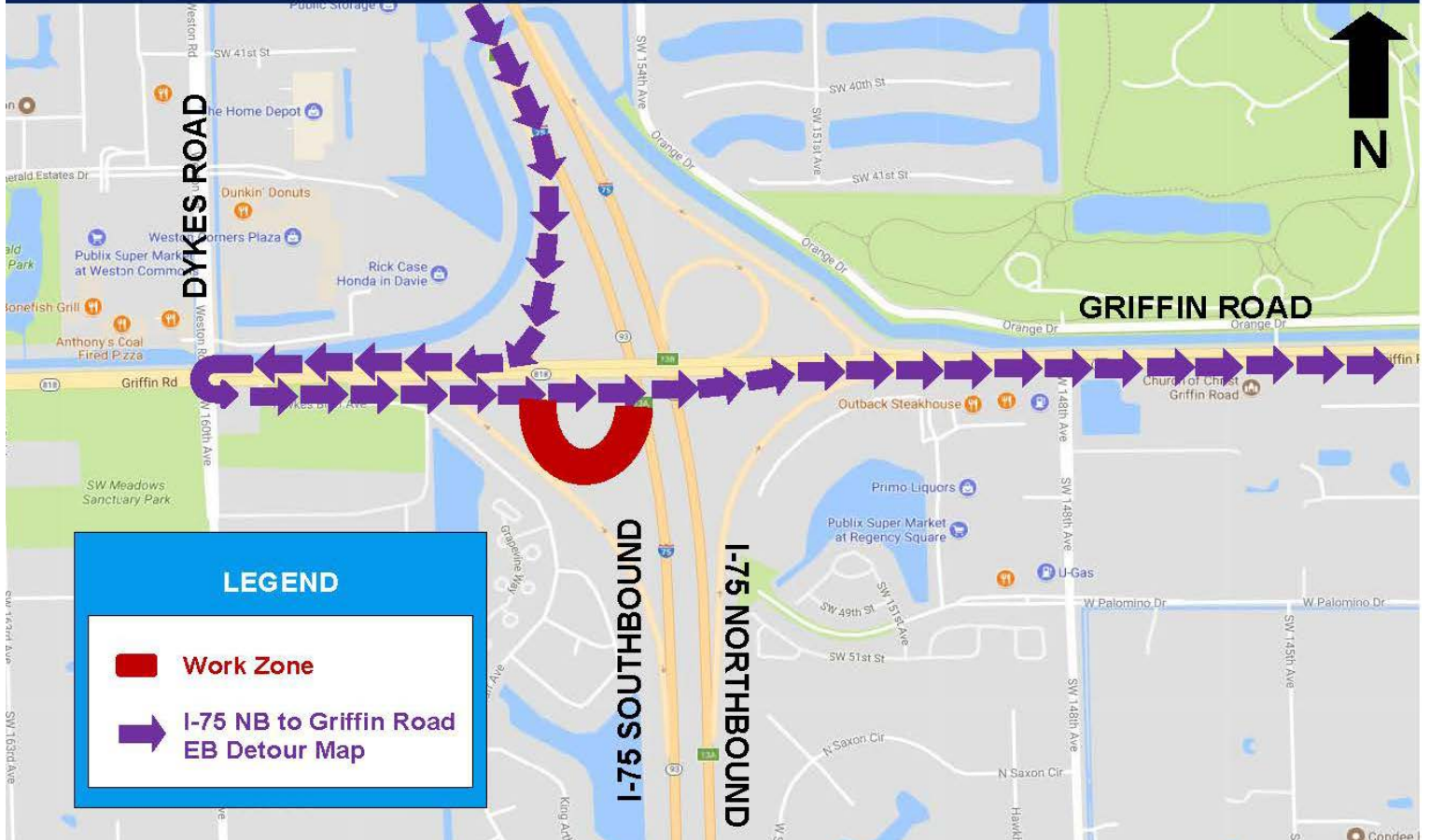

Please note that this schedule may change due to inclement weather or other unexpected conditions.

CONTACT

For more information or to receive updates, please contact the project Public Information Officer, Gerdy St. Louis, at 954.548.2754 or via e-mail at gerdy@iscprgroup.com

STAY CONNECTED



75-express.com



[@myfdot_sefl](https://twitter.com/myfdot_sefl)



www.fl511.com



smartsunguide.com



I-75 SOUTHBOUND ENTRANCE RAMP DETOUR FOR GRIFFIN ROAD



The I-75 southbound entrance ramp from eastbound and westbound Griffin Road will be closed Tuesday, August 15 through Thursday, August 17 between 10 p.m. and 6 a.m. Motorists traveling eastbound and westbound on Griffin Road will be detoured to Flamingo Road, then south on Flamingo Road to Sheridan Street and west on Sheridan Street to take the I-75 southbound entrance ramp. Please follow the posted detour. If necessary to complete this work, these ramp closures will also take place from 10 p.m. Thursday, August 17 to 6 a.m. Friday, August 18. Please also note that this schedule may change due to inclement weather or other unexpected conditions.

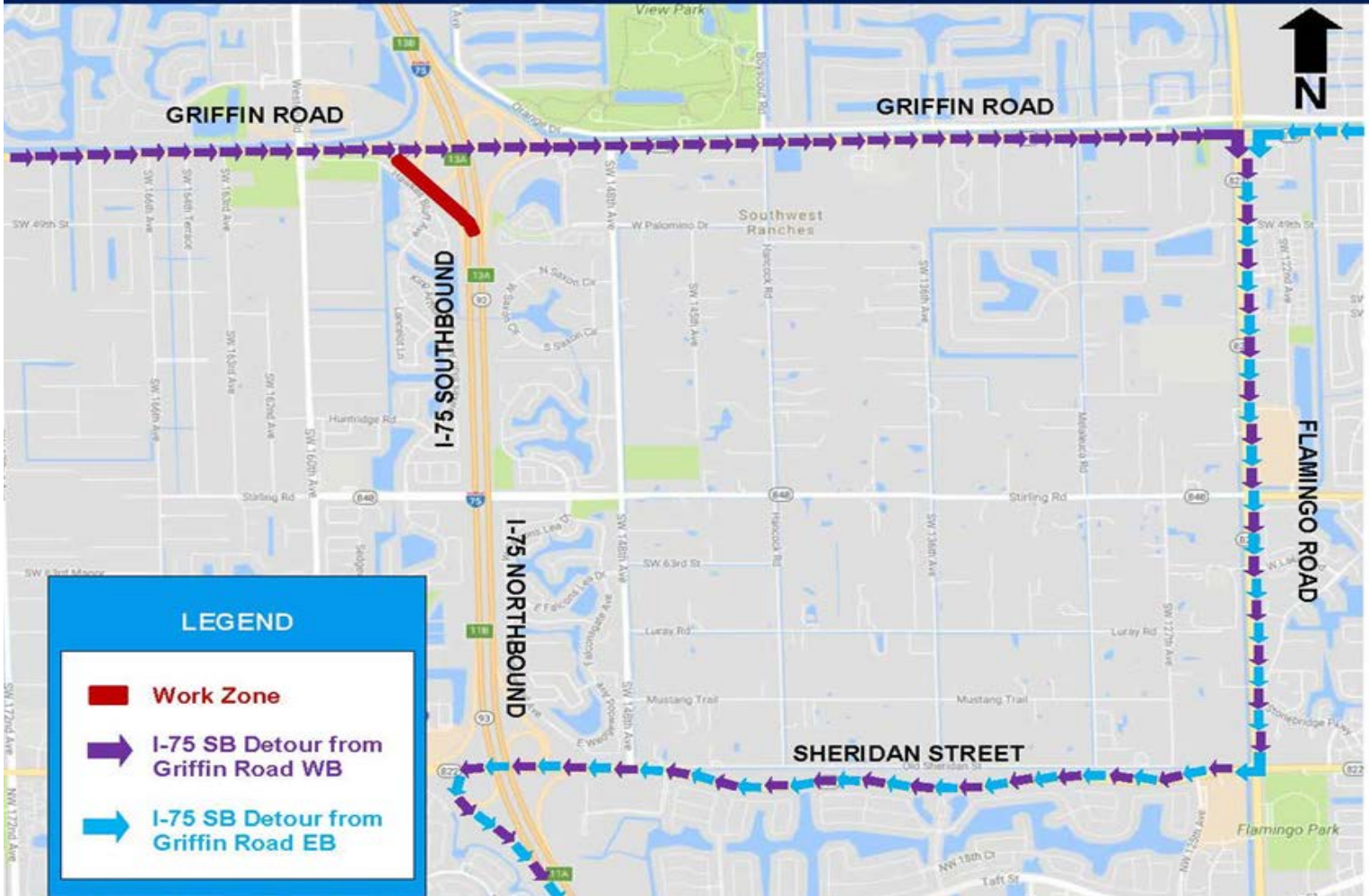

Please note that this schedule may change due to inclement weather or other unexpected conditions.

CONTACT

For more information or to receive updates, please contact the project Public Information Officer, Gerdy St. Louis, at 954.548.2754 or via e-mail at gerdy@iscprgroup.com

STAY CONNECTED



75-express.com



[@myfdot_sefl](https://twitter.com/myfdot_sefl)



www.fl511.com



smartsunguide.com