

# 75 EXPRESS LANE PROJECT



## CONSTRUCTION UPDATE



### I-75 Ramp Closures at Griffin Road Scheduled to Continue Tuesday, September 5

The Florida Department of Transportation (FDOT) is scheduled to close the I-75 northbound and southbound exit ramps at Griffin Road to complete paving and guardrail operations. In order to perform the work safely, traffic will be detoured during the following dates and times:

- The I-75 northbound exit ramp to westbound Griffin Road (Exit 13B) will be closed intermittently Tuesday, September 5 through Thursday, September 7 between 10 p.m. and 5 a.m. Motorists will be detoured to exit at Sheridan Street East (Exit 11), continue east on Sheridan Street to Flamingo Road and north on Flamingo Road to Griffin Road. Please follow the posted detour.
- The I-75 southbound exit ramp to eastbound Griffin Road (Exit 13A) will be closed intermittently Tuesday, September 5 through Thursday, September 7 between 10 p.m. and 5 a.m. Motorists will be detoured to exit at Griffin Road West (Exit 13B), continue west on Griffin Road to Dykes Road and make a U-turn at Dykes Road to go east. Please follow the posted detour.

**Please be advised that these ramp closures will not occur simultaneously. Please also note that this schedule may change due to inclement weather or other unexpected conditions.**

#### CONTACT

For more information or to receive updates, please contact the project Public Information Officer, Gerdy St. Louis, at 954.548.2754 or via e-mail at [gerdy@iscprgroup.com](mailto:gerdy@iscprgroup.com)

#### STAY CONNECTED



[75-express.com](http://75-express.com)



[@myfdot\\_sefl](https://twitter.com/myfdot_sefl)



[www.fl511.com](http://www.fl511.com)



[smartsunguide.com](http://smartsunguide.com)



# I-75 NORTHBOUND TO GRIFFIN ROAD WESTBOUND DETOUR MAP



The I-75 northbound exit ramp to westbound Griffin Road (Exit 13B) will be closed intermittently Tuesday, September 5 through Thursday, September 7 between 10 p.m. and 5 a.m. Motorists will be detoured to exit at Sheridan Street East (Exit 11), continue east on Sheridan Street to Flamingo Road and north on Flamingo Road to Griffin Road. Please follow the posted detour. Please also note that this schedule may change due to inclement weather or other unexpected conditions.

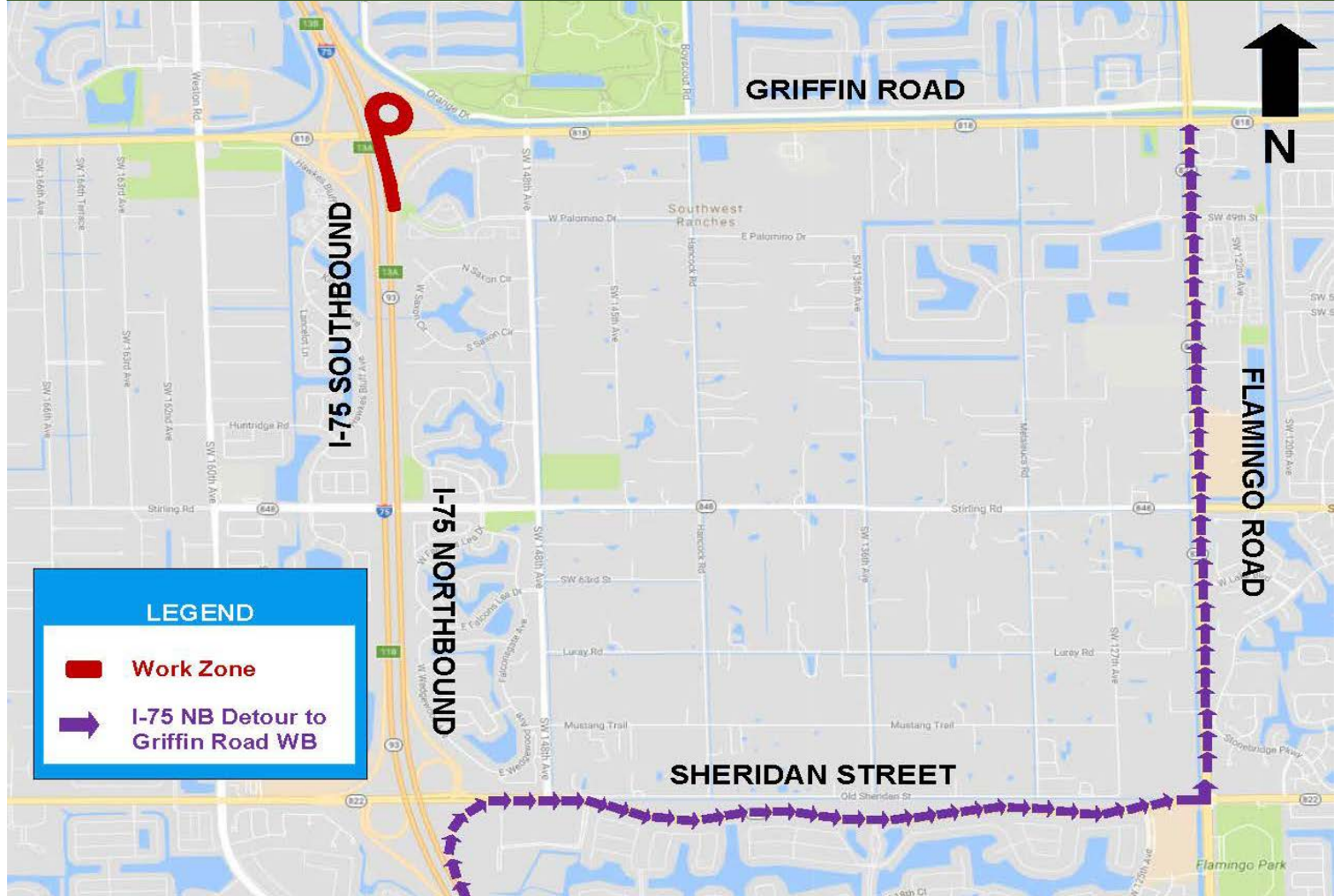

**Please note that this schedule may change due to inclement weather or other unexpected conditions.**

### CONTACT

For more information or to receive updates, please contact the project Public Information Officer, Gerdy St. Louis, at 954.548.2754 or via e-mail at [gerdy@iscprgroup.com](mailto:gerdy@iscprgroup.com)

### STAY CONNECTED





# I-75 SOUTHBOUND TO GRIFFIN ROAD EASTBOUND DETOUR MAP



The I-75 southbound exit ramp to eastbound Griffin Road (Exit 13A) will be closed intermittently Tuesday, September 5 through Thursday, September 7 between 10 p.m. and 5 a.m. Motorists will be detoured to exit at Griffin Road West (Exit 13B), continue west on Griffin Road to Dykes Road and make a U-turn at Dykes Road to go east. Please follow the posted detour. Please also note that this schedule may change due to inclement weather or other unexpected conditions.

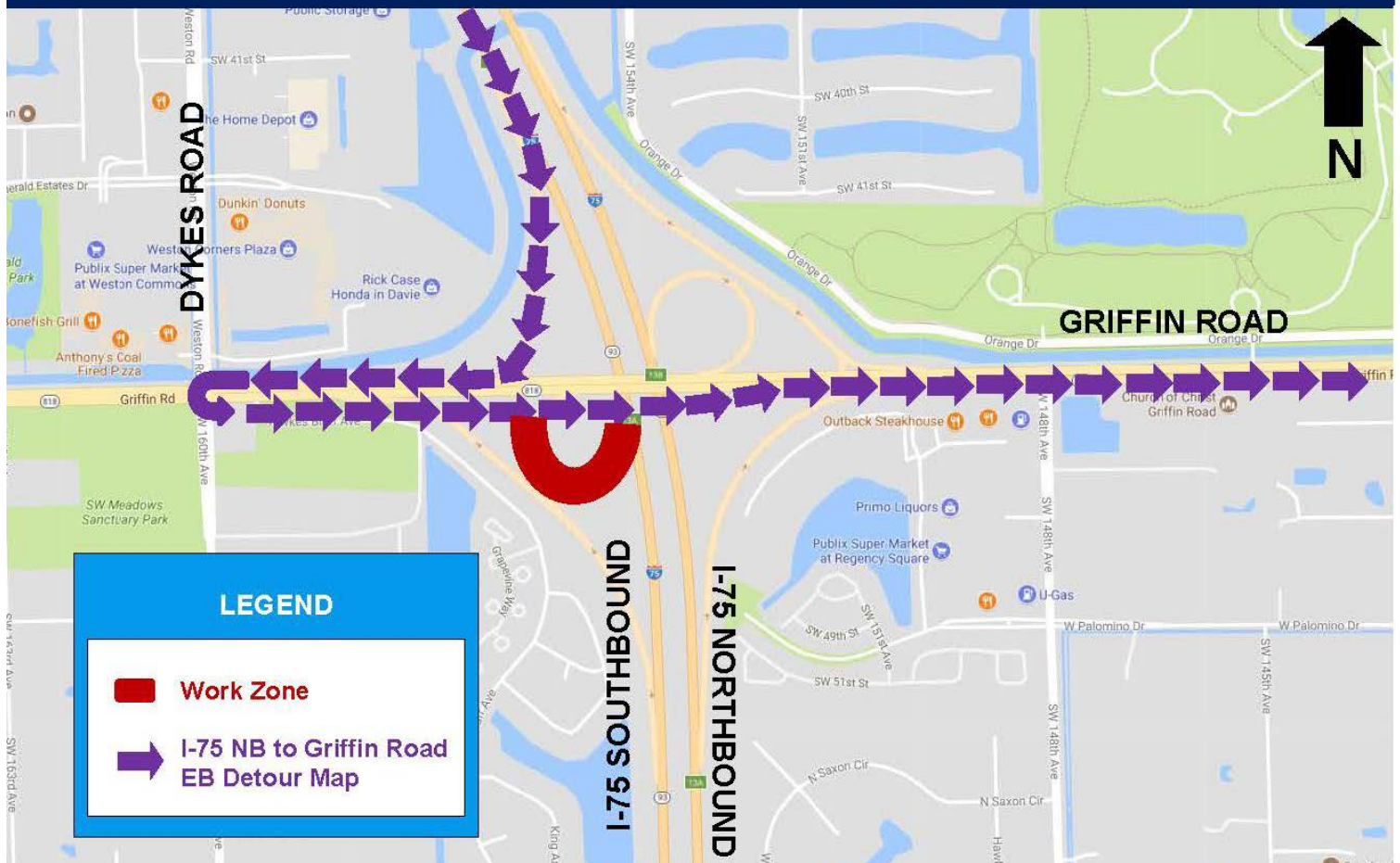

**Please note that this schedule may change due to inclement weather or other unexpected conditions.**

### CONTACT

For more information or to receive updates, please contact the project Public Information Officer, Gerdy St. Louis, at 954.548.2754 or via e-mail at [gerdy@iscprgroup.com](mailto:gerdy@iscprgroup.com)

### STAY CONNECTED

  
[75-express.com](http://75-express.com)

  
[@myfdot\\_sefl](https://twitter.com/myfdot_sefl)

  
[www.fl511.com](http://www.fl511.com)

  
[smartsunguide.com](http://smartsunguide.com)

