



CONSTRUCTION UPDATE

Full Closures on I-75 at Royal Palm Scheduled to Begin on Wednesday, March 23

The Florida Department of Transportation (FDOT) is scheduled to close lanes on I-75 southbound at Royal Palm Boulevard to install an overhead sign structures for the 75 Express project. In order to perform the work safely, traffic will be detoured during the following dates and times:

- **Full Closure on I-75 Southbound at Royal Palm Boulevard**

All lanes of I-75 southbound at Royal Palm Boulevard will be closed nightly from 10 p.m. to 5:30 a.m. on Wednesday, March 23 and Thursday, March 24. Closures will continue on Sunday, March 27. Motorists will be able to take the exit ramp to Royal Palm Boulevard (Exit 15), go west on Royal Palm Boulevard to Weston Road, south on Weston Road, continue east on Griffin Road and then take the entrance ramp to re-enter southbound I-75.

Please note that this schedule may change due to inclement weather or other unexpected conditions.

CONTACT

For more information or to receive updates, please contact the project Public Information Officer, Fiorella Teodista, at 954.548.2754 or via e-mail at fiorella@iscprgroup.com



I-75 SOUTHBOUND AT ROYAL PALM BOULEVARD DETOUR MAP



**Nightly Full Closures from 10 p.m. to 5:30 a.m.
on Wednesday, March 23, Thursday, March 24
and Sunday, March 27.**

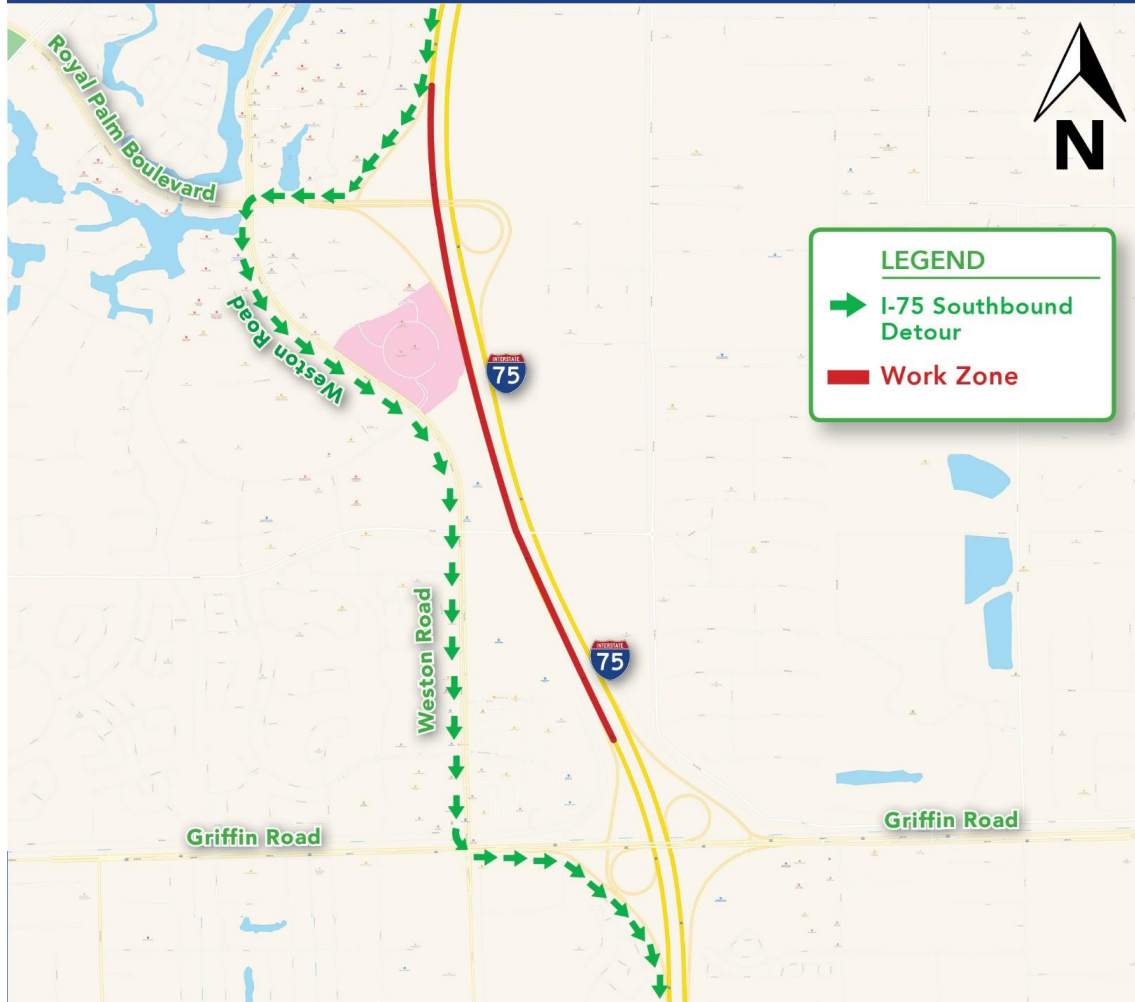

STAY CONNECTED

